



Vamos construir o futuro que queremos!
Lets build the future we want!

Passive House para todos!
Passive House for all!



Apoio técnico:

Carlos Reis
(+351) 925 778 067
carlos.reis@saint-gobain.com



ISOVER
SAINT-GOBAIN



Ventilação com recuperação de calor

Autor:

Carlos Reis, ISOVER

Conduitas fono-absorventes

$\lambda = 0,032 \text{ W/m}^\circ\text{C}$ $T \text{ máx: } 90^\circ\text{C}$ $V \text{ máx: } 18 \text{ m/s}$



CLIMAVER A1 APTA

esp. 40 mm - revestim. tecido *neto*

Secção [mm x mm]	Atenuação acústica c/ CLIMAVER A1 APTA [dB/m]					
	125 Hz	250 Hz	500 Hz	1000 Hz	2000 Hz	4000 Hz
200 x 200	5,8	12,8	16,7	16,7	18,1	21,0
300 x 400	3,4	7,4	9,8	9,8	10,6	12,2
400 x 700	2,3	5,0	6,6	6,6	7,1	8,2



CLIMAVER PLUS R / A2 PLUS

esp. 25 mm - revestim. int. alumínio

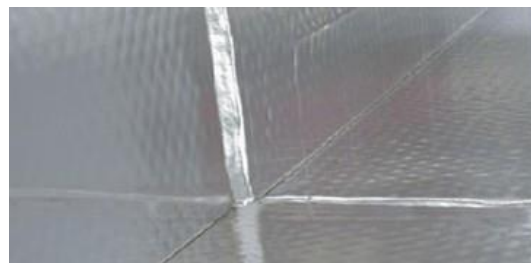



● **CLIMAVER A2 DECO**

espessura 25 mm

revestim. interior tecido **neto**

revestim. exterior decorativo

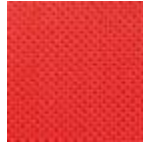

● **CLIMAVER NETO / A2 NETO**

esp. 25 mm - revestim. tecido **neto**

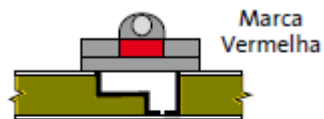

Ferramenta com marca vermelha.
Corte a meia espessura para fixar o painel a 90

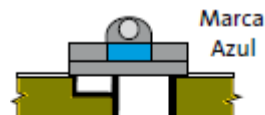

Ferramenta com marca azul.
Cria rebordos com abas para o fecho da conduta.

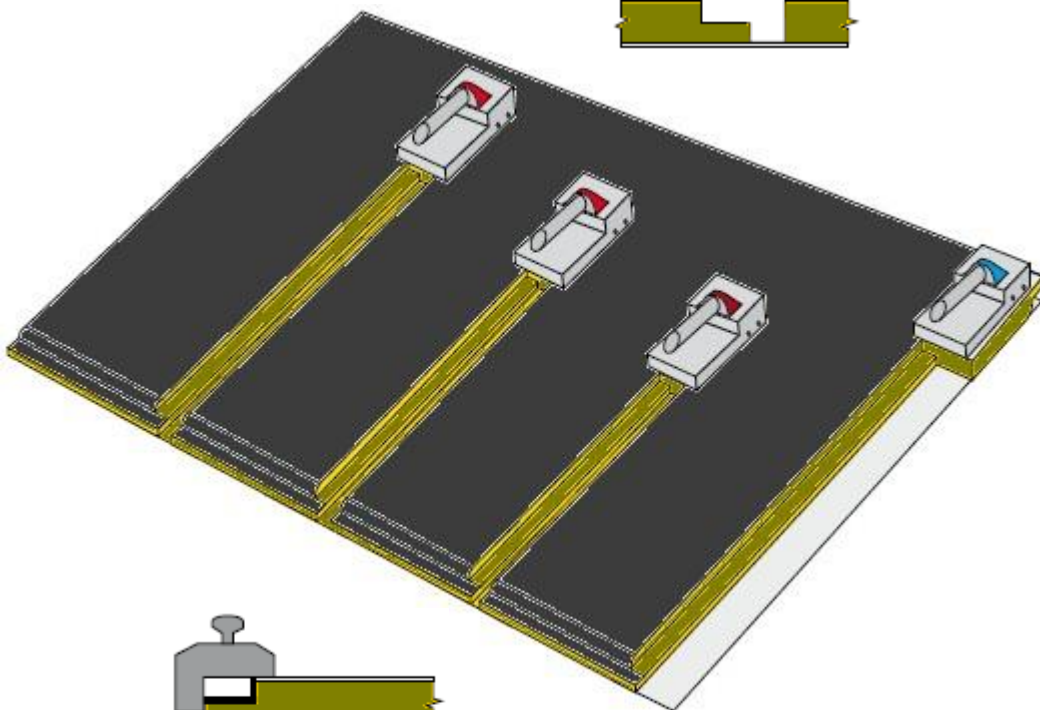

Ferramenta com marca negra. Realiza cantos para criar tampas



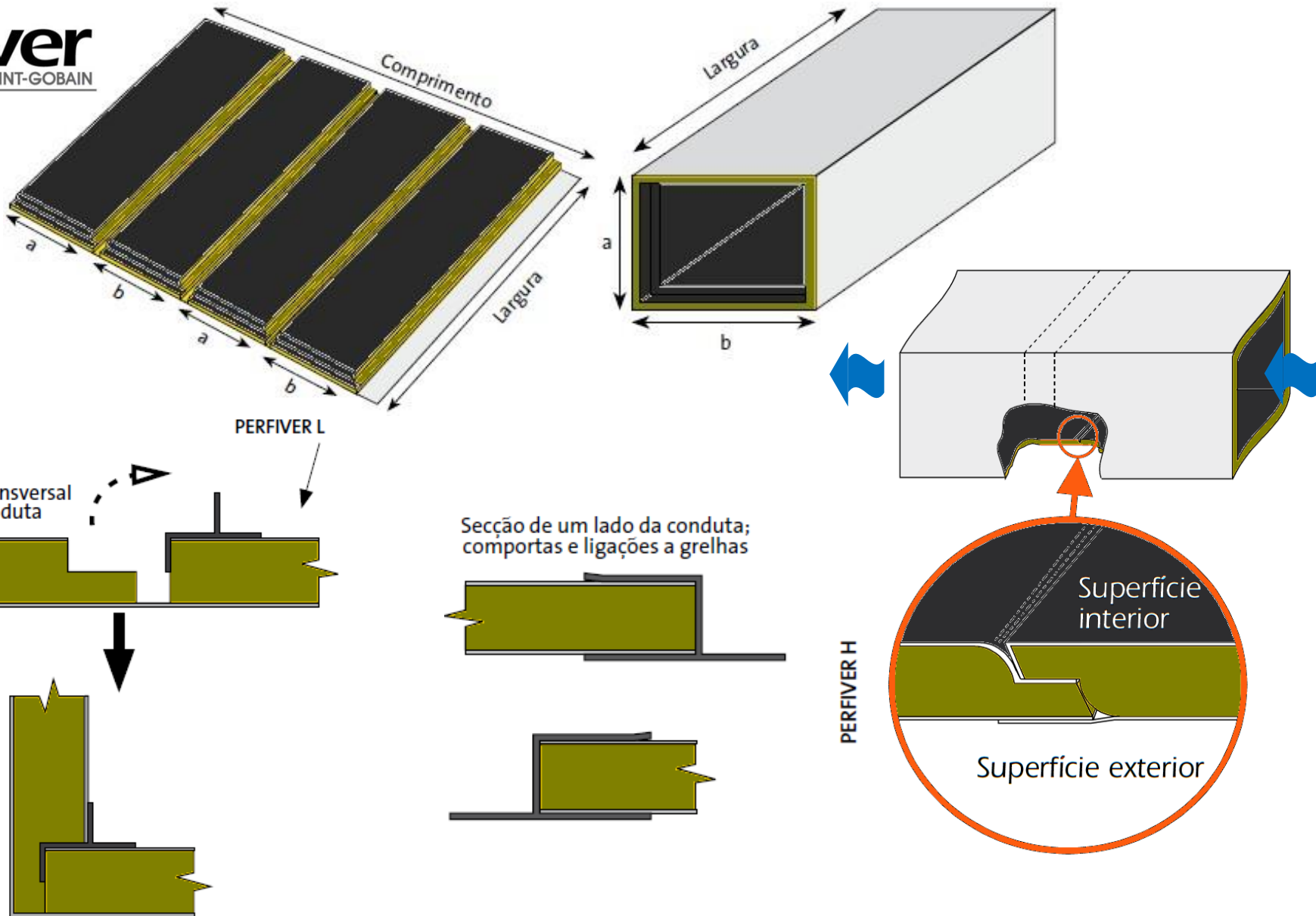

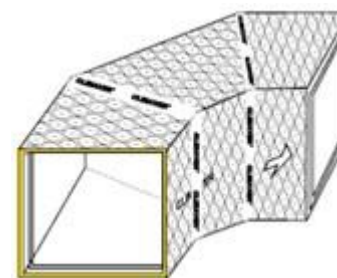
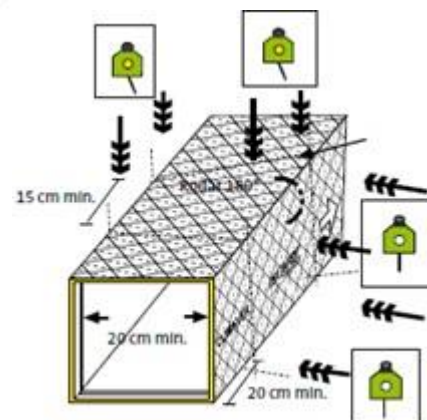
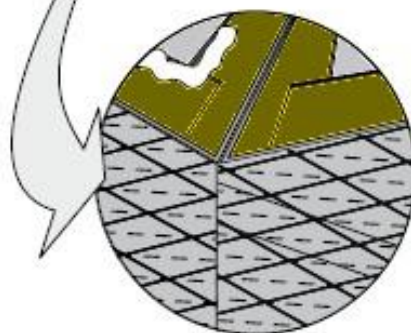
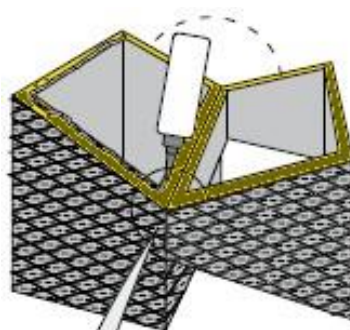
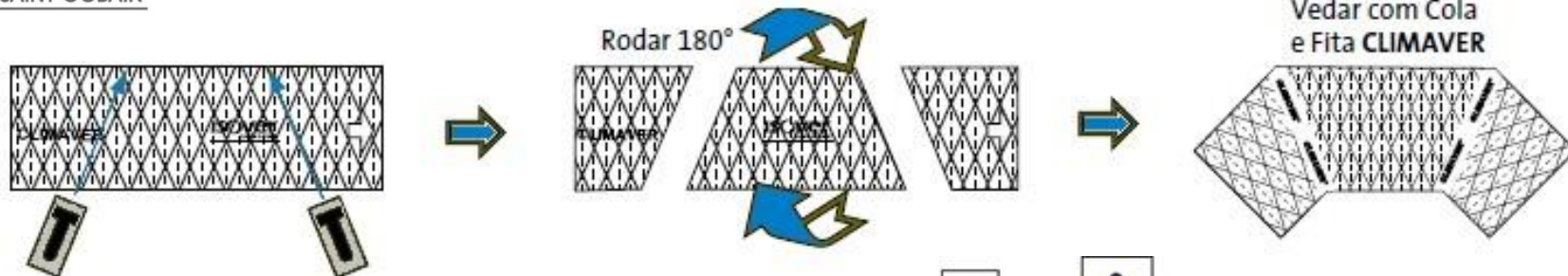

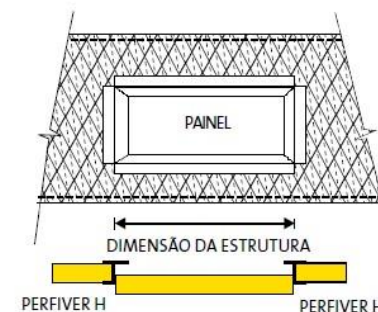
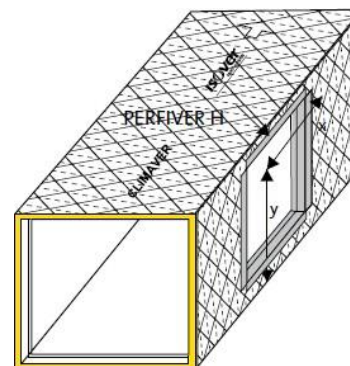
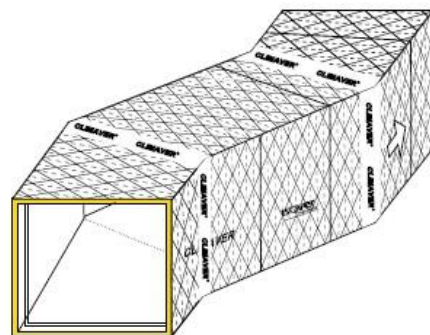
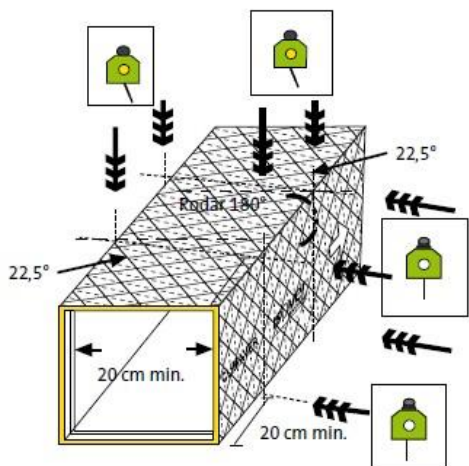
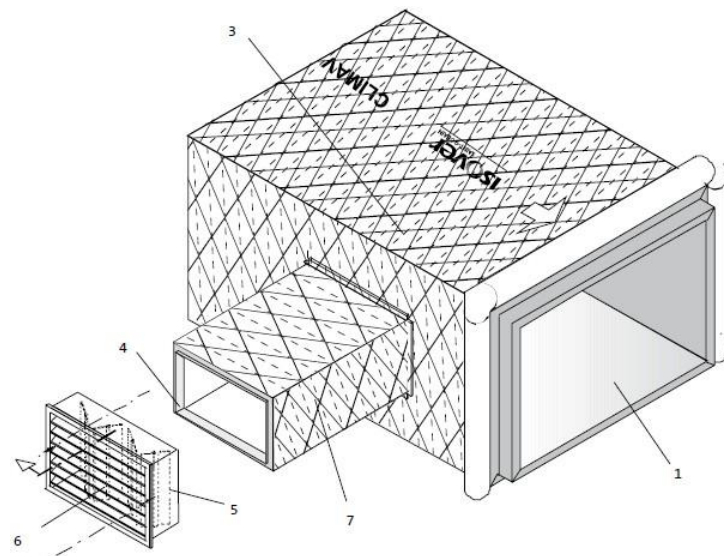
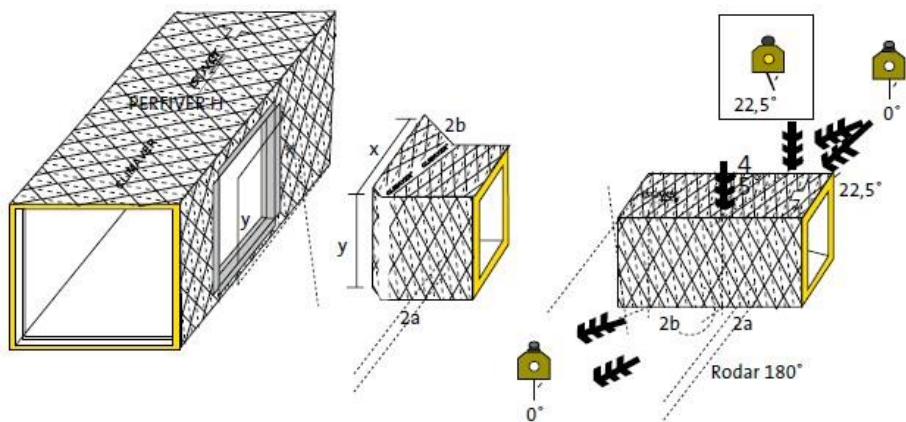

CLIMAVER STAR

Primeira conduta autoportante para aplicação no exterior

Revestimento com proteção aos raios UV

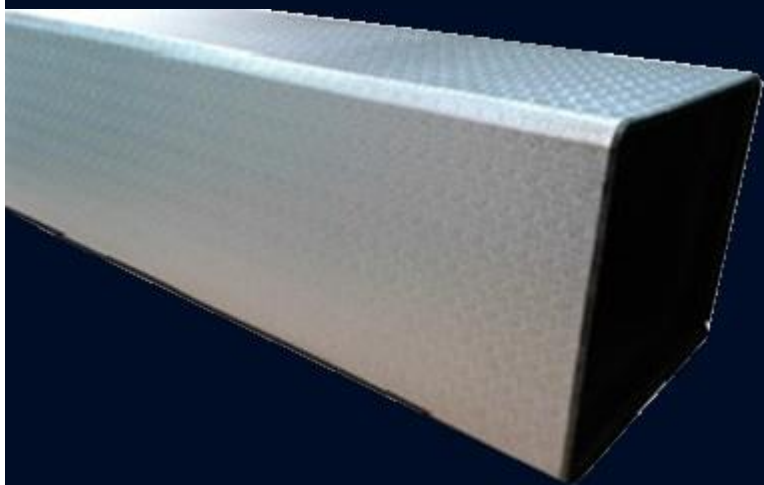
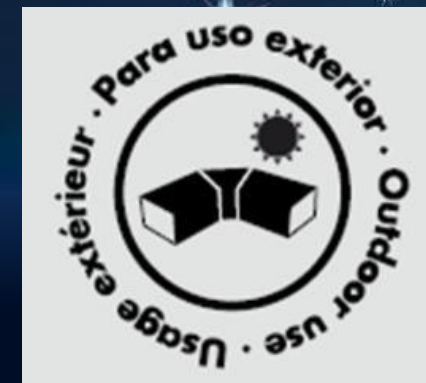

Espessura = 40 mm, $\lambda = 0,032 \text{ W/m}^\circ\text{C}$

Não requer proteção mecânica

revestim. interior tecido *neto*